

**NECK DETAIL**

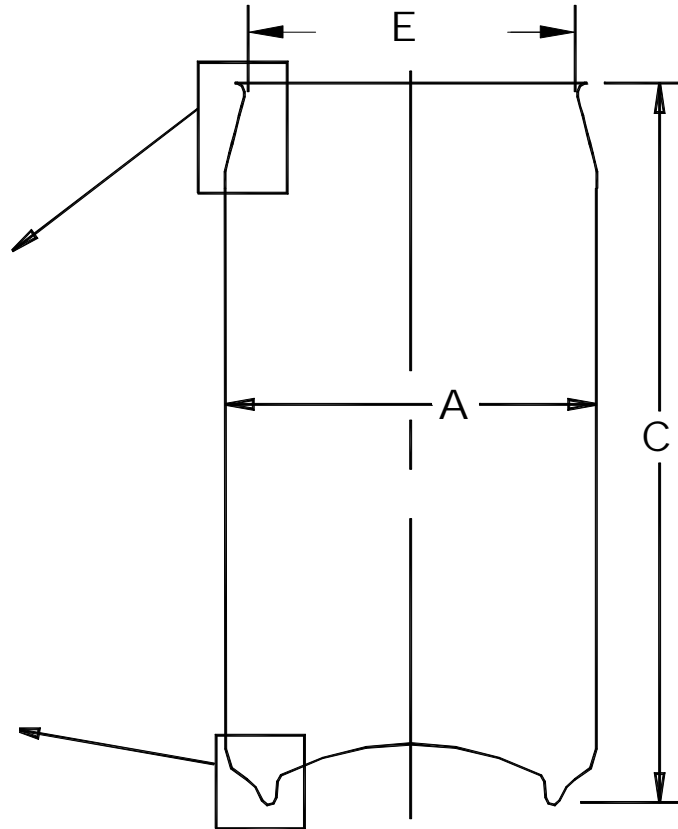

**NECKED & FLANGED CAN**

		US STANDARD	METRIC
A	BODY OUTSIDE DIAMETER	2.600 $\pm$ .008	66,04 $\pm$ 0,20
B	FLANGE WIDTH	.082 $\pm$ .010	2,08 $\pm$ 0,25
C	FLANGED CAN HEIGHT	4.812 $\pm$ .015	122,22 $\pm$ 0,38
D	COLUMN STRENGTH	MIN	PER CUSTOMER REQUIREMENT
E	NECK PLUG DIAMETER	2.063 $\pm$ .007	52,40 $\pm$ 0,18
F	FILL VOLUME	12.00 $\pm$ .06	355,00 $\pm$ 1,77
G	FREEBOARD	.470 $\pm$ .020	11,94 $\pm$ 0,51
H	MATERIAL	H-19 ALUM	
J	DOME REVERSAL PRESSURE	MIN 90 PSI	620 PKA
K	FLANGE ANGLE	12° MAX	

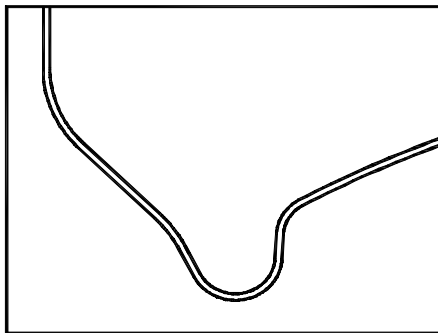

METAL BEVERAGE CONTAINER OPERATIONS  
9300 W. 108TH CIRCLE

WESTMINSTER, CO 80021-3682  
P.O. BOX 589, BROOMFIELD, CO 80038-0589

THE DESIGNS, INFORMATION AND DATA CONTAINED HEREIN ARE PROPRIETARY AND ARE SUBMITTED IN CONFIDENCE, AND SHALL NOT BE DISCLOSED, USED OR DUPLICATED IN WHOLE OR IN PART, FOR ANY PURPOSES WHATSOEVER WITHOUT THE PRIOR WRITTEN PERMISSION OF BALL CORPORATION. RECEIPT OF THIS DOCUMENT SHALL BE DEEMED TO BE AN ACCEPTANCE OF THE CONDITIONS SPECIFIED HEREIN.

202/211 X 413  
12 OZ  
INDUSTRY STANDARD  
BEVERAGE / BEER  
MANUFACTURING SPECIFICATIONS

PRODUCT STANDARD  
  
CS-A0934

DATE CREATED  
8/25/00  
APPROVED  
B THOMAS

CREATED BY  
N ZANETELL  
APPROVED  
T NGUYEN

DATE REVISED  
09/01/11  
REV.  
H