

NECK DETAIL

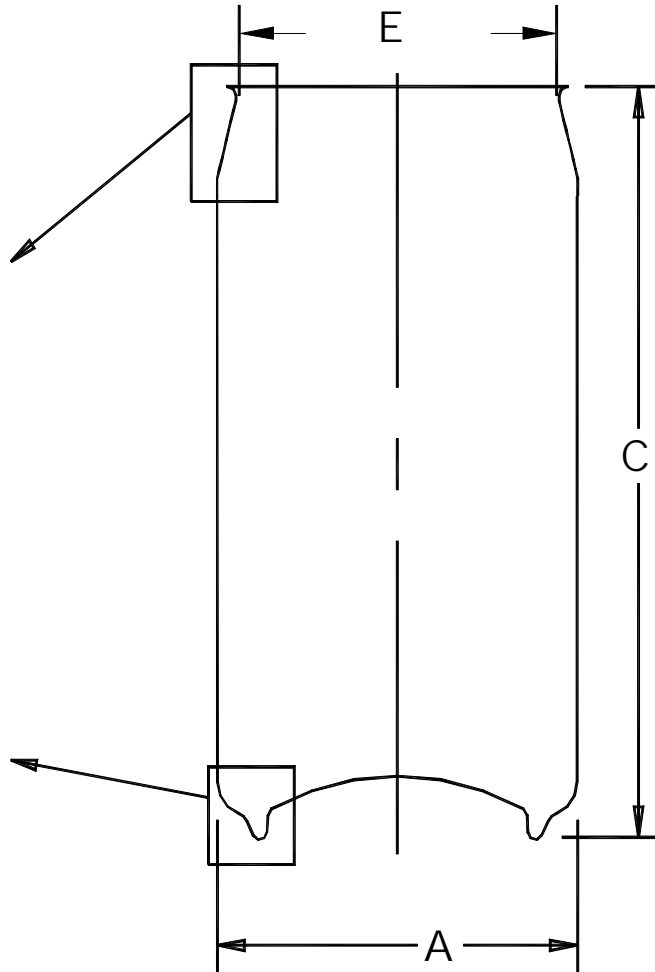
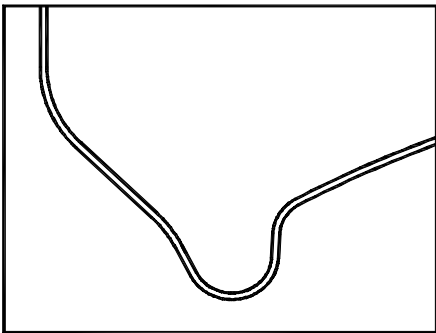

NECKED & FLANGED CAN

A	BODY OUTSIDE DIAMETER	(in)	2.600 ± 0.008	
B	FLANGE WIDTH	(in)	0.082 ± 0.010	
C	FLANGED CAN HEIGHT	(in)	6.190 ± 0.015	
D	COLUMN STRENGTH	min	PER CUSTOMER REQUIREMENT	
E	NECK PLUG DIAMETER		2.063 ± 0.007	
F	FILL VOLUME	(FL OZ)	BEER / BEV	RETORT
			16.00 ± 0.06	15.00 - 15.25 ± 0.06**
G	FREEBOARD	(in)	0.470 ± 0.020	
H	MATERIAL		H-19 ALUM	
J	DOMES REVERSAL PRESSURE	(PSI)	90 MIN	
K	FLANGE ANGLE		12° MAX	

****RETORT VOLUMES MAY VARY SLIGHTLY DEPENDING ON PRODUCT, FILL CONTROL CAPABILITIES & LIQUID NITROGEN INJECTION**



METAL BEVERAGE CONTAINER OPERATIONS
 9300 W. 108TH CIRCLE
 WESTMINSTER, CO 80021-3682
 P.O. BOX 589, BROOMFIELD, CO 80038-0589

202/211 X 603 STANDARD
 BEVERAGE/BEER CAN

16 oz
 MANUFACTURING SPECIFICATION

DATE CREATED	APPROVED
4/17/03	W Thomas
CREATED BY	APPROVED
N Zanetell	B Bass

THE DESIGNS, INFORMATION AND DATA CONTAINED HEREIN ARE PROPRIETARY AND ARE SUBMITTED IN CONFIDENCE, AND SHALL NOT BE DISCLOSED, USED OR DUPLICATED IN WHOLE OR IN PART, FOR ANY PURPOSES WHATSOEVER WITHOUT THE PRIOR WRITTEN PERMISSION OF BALL CORPORATION. RECEIPT OF THIS DOCUMENT SHALL BE DEEMED TO BE AN ACCEPTANCE OF THE CONDITIONS SPECIFIED HEREIN.

PRODUCT STANDARD

CS-A0953

DATE REVISED	REV.
09/01/11	D