

NECK DETAIL

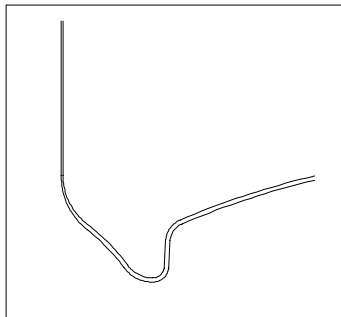

B-13
DOME DETAIL

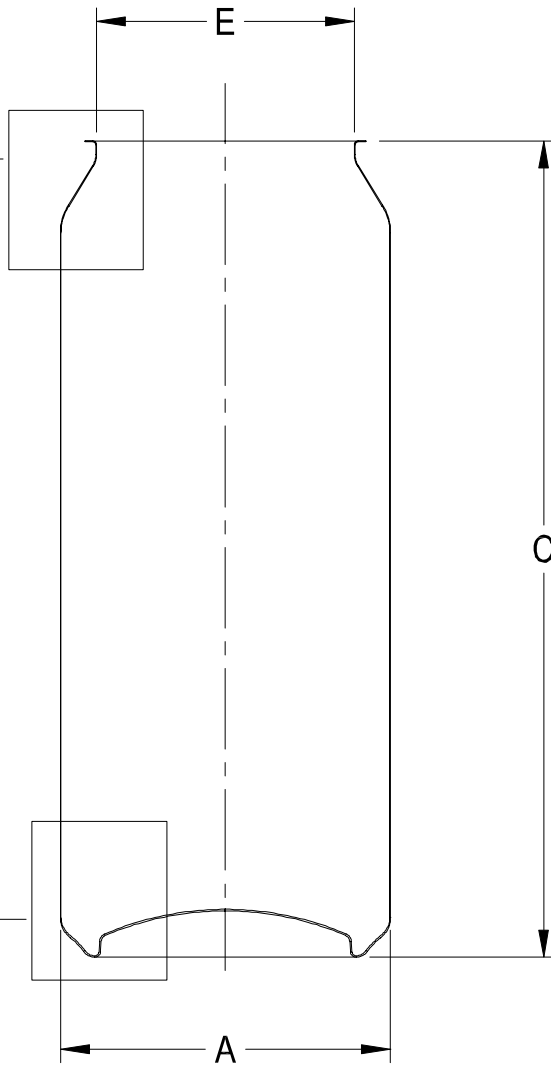

NECKED & FLANGED CAN

A	BODY OUTSIDE DIAMETER	(in)	2.881 ± 0.007
B	FLANGE WIDTH	(in)	0.088 ± 0.008
C	FLANGED CAN HEIGHT	(in)	7.604 ± 0.015
D	COLUMN STRENGTH	(lbs)	180 MIN
E	NECK PLUG DIAMETER	(in)	2.260 ± 0.007
F	FILL VOLUME	(FL OZ)	24.00 ± 0.06
G	FREEBOARD	(in)	0.600 ± 0.020
H	MATERIAL		ALUM
J	DOME REVERSAL PRESSURE	(PSI)	90 MIN
K	FLANGE ANGLE		12° MAX



METAL BEVERAGE CONTAINER OPERATIONS
9300 W. 108TH CIRCLE
WESTMINSTER, CO 80021-3682
P.O. BOX 589, BROOMFIELD, CO 80038-0589

THE DESIGNS, INFORMATION AND DATA CONTAINED HEREIN ARE PROPRIETARY AND ARE SUBMITTED IN CONFIDENCE, AND SHALL NOT BE DISCLOSED, USED OR DUPLICATED IN WHOLE OR IN PART, FOR ANY PURPOSES WHATSOEVER WITHOUT THE PRIOR WRITTEN PERMISSION OF BALL CORPORATION. RECEIPT OF THIS DOCUMENT SHALL BE DEEMED TO BE AN ACCEPTANCE OF THE CONDITIONS SPECIFIED HEREIN.

206/300 X 710
BEVERAGE/BEER CAN
24 oz

DATE CREATED
3/12/03

APPROVED
M Hager

CREATED BY
N Zanetell

APPROVED
B Bass

PRODUCT STANDARD

CS-A0949

DATE REVISED

03/15/04

REV.

D