

NECK DETAIL

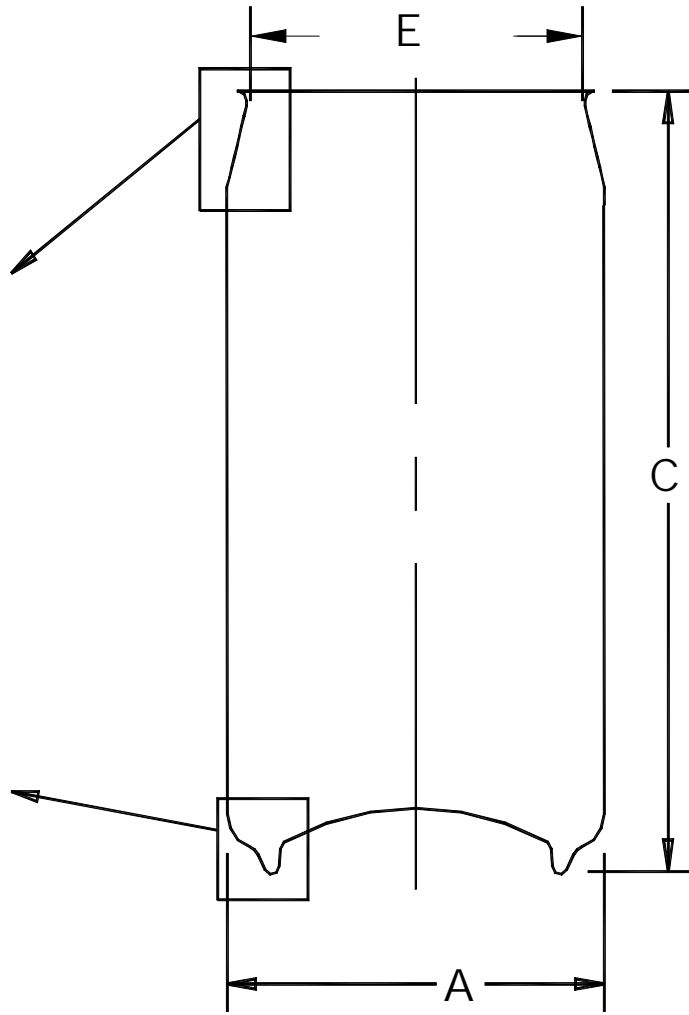

NECKED & FLANGED CAN

		WITH BRE END	STANDARD END
A	BODY OUTSIDE DIAMETER (in)	2.595 ± 0.008	
B	FLANGE WIDTH (in)	0.082 ± 0.010	
C	FLANGED CAN HEIGHT (in)	7.405 ± 0.015	
D	COLUMN STRENGTH (lbs)	180 MIN	
E	NECK PLUG DIAMETER	2.063 ± 0.007	
F	FILL VOLUME (ml)	550 ± 1.8	568 ± 1.8
G	FREEBOARD (in)	.779 ± .020	.566 ± .020
H	MATERIAL	H-19 ALUM	
J	DOMES REVERSAL PRESSURE (PSI)	90 MIN	
K	FLANGE ANGLE	12° MAX	

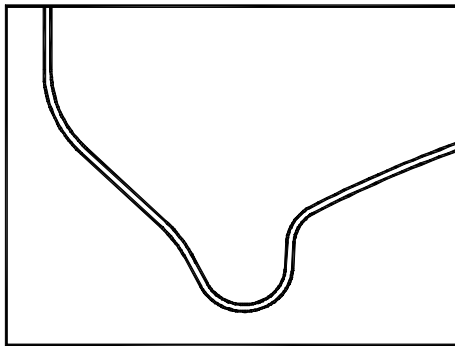

METAL BEVERAGE CONTAINER OPERATIONS
 9300 W. 108TH CIRCLE
 WESTMINSTER, CO 80021-3682
 P.O. BOX 589, BROOMFIELD, CO 80038-0589

THE DESIGNS, INFORMATION AND DATA CONTAINED HEREIN ARE PROPRIETARY AND ARE SUBMITTED IN CONFIDENCE, AND SHALL NOT BE DISCLOSED, USED OR DUPLICATED IN WHOLE OR IN PART, FOR ANY PURPOSES WHATSOEVER WITHOUT THE PRIOR WRITTEN PERMISSION OF BALL CORPORATION. RECEIPT OF THIS DOCUMENT SHALL BE DEEMED TO BE AN ACCEPTANCE OF THE CONDITIONS SPECIFIED HEREIN.

202/211 X 707
 BEVERAGE
 568ml / 550ml (BRE END)
 MANUFACTURING SPECIFICATION

PRODUCT STANDARD

CS-A1124

DATE CREATED 11/4/10	APPROVED WRENSHALL
CREATED BY N Zanetell	APPROVED B BASS

DATE REVISED 08/23/11	REV. B.
--------------------------	------------